



**TRI LUX**  
SIMPLIFY YOUR LIGHT.

# XTREME GYM

Boosting studio growth with quality lighting!, Poland

# Xtreme Gym

## Boosting studio growth with quality lighting!

The successful Polish fitness group, Xtreme Gym, has modernized the lighting in all its existing and upcoming studios using the E-Line continuous line system from TRILUX. Xtreme Gym is a Polish gym chain with 53 branches and an ambitious expansion plan. By the end of 2027, the company aims to have 227 studios across Poland. Their focus is not only on state-of-the-art training equipment but also on equally advanced lighting solutions.

They sought a linear lighting solution that would meet high project-specific requirements, including energy efficiency, durability and design, and could be standardized across all locations. Our portfolio of solutions and services met their needs perfectly.

**Address**

Błonie 2, 33-100 Tarnów,  
Poland

**Lightplanner**

Maciej Gronert











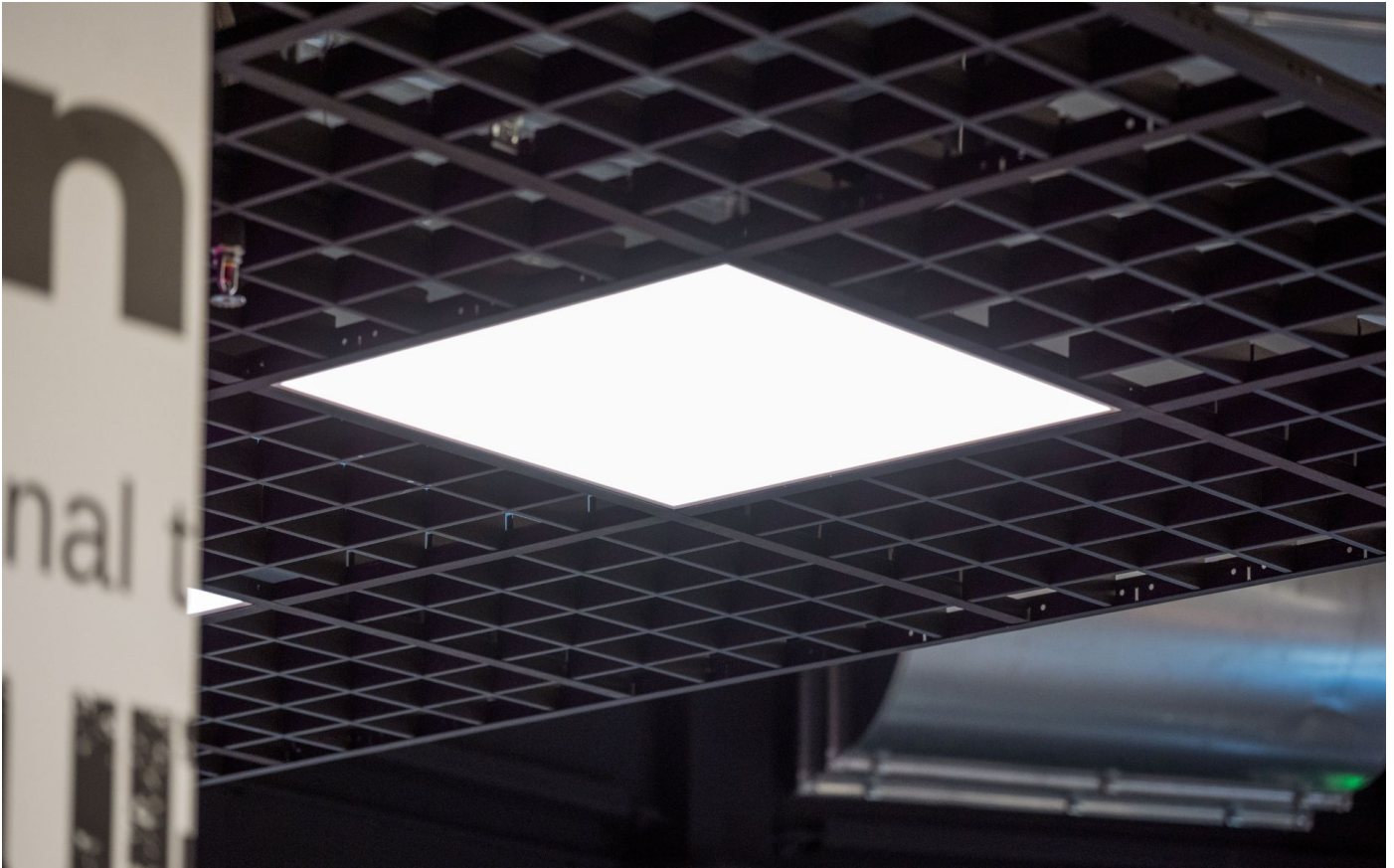

## A professional partner found

The decision to collaborate hinged on several factors. First, the economic advantages of our continuous line system, with E-Line delivering efficiency of up to 190 lm/W and a service life of up to 100,000 hours. Additionally, the design and support services also played an important role.

"We wanted a design that blends attractively into the premises, offer simple installation for the contractors, and provide maximum functionality and flexibility in lighting control and configuring. TRILUX met all our expectations," says project manager Daniel Idus from Xtreme Gym, explaining the reasons for the collaboration.



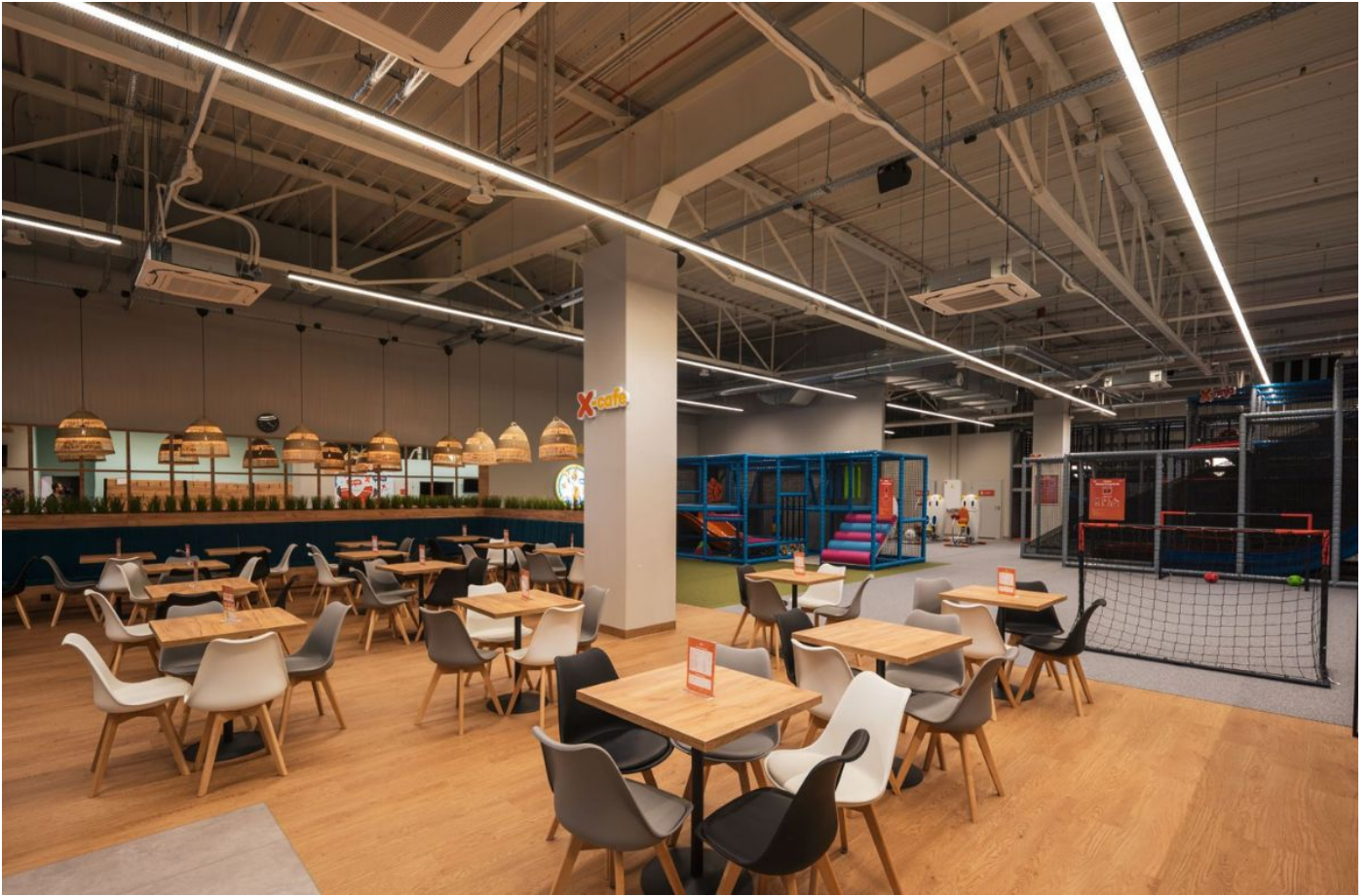









## LUMINAIRE DESIGN

### A minimalist design language

Minimal frame, maximum lighting effect: To create an inviting atmosphere in the studios, the lighting needed to be as subtle as possible, focusing on delivering high-quality, attractive light. This made our E-Line an ideal choice. The timeless, elegant continuous line system features lens optics with wide beam light distribution, ensuring optimum visual conditions and an attractive ambience thanks to its pleasantly uniform light.





## EVERY STUDIO IS UNIQUE

"The varying architectural and lighting conditions in each studio posed a planning challenge, requiring ongoing adaptation of the lighting design throughout the project," recalls Maciej Gronert, the dedicated TRILUX project manager. The process and result impressed Xtreme Fitness. "TRILUX's service was of a high standard. Each step is meticulously planned, down to the last detail by their sales and design team. TRILUX values customer engagement and always puts it first. We are very satisfied with the results," summarizes Daniel Idus from Xtreme Gym. We wholeheartedly agree and look forward to continuing our collaboration.

## MORE PICTURES



## USED PRODUCTS



### E-LINE

From experience. From the market. For the future.



### E-LINE PRO

A combination of experience and evolution