



## PROJECT: TRILUX LICHT CAMPUS



### Project information

Architect: GRAFT, Berlin

City: 50829 Köln / Germany

## PROJECT DETAILS

### Project images

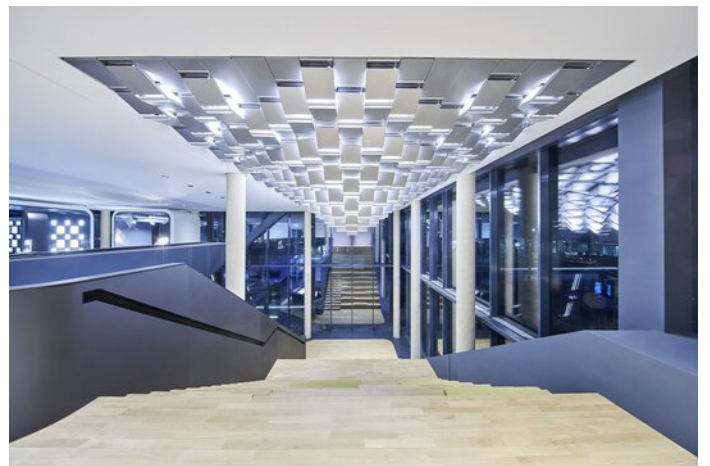



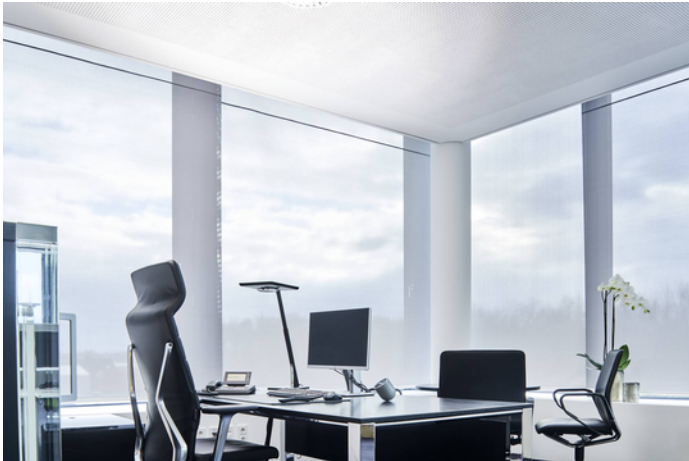
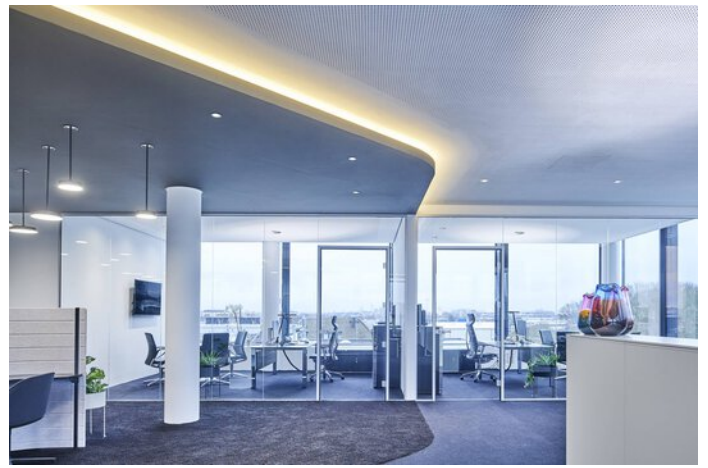





## Products used



### **Bicult LED desktop luminaire**

Bicult LED is the first desktop luminaire in the market to combine direct and indirect light output, thereby ensuring standard-compliant lighting. In addition to freedom of glare, flexibility and individual light settings are the main focus points.



### **Parelia LED suspended luminaire**

The continuous line-capable Parelia LED is perfect for lighting concepts parallel to the building axis. The luminaire can be positioned centrally above the desk without the direct component causing reflected glare. The lateral light line creates an attractive room atmosphere.

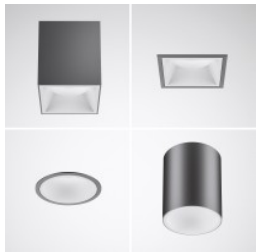

### **Sonnos**

Many functions and one world of design: the modularly designed Sonnos LED range of downlights can implement all lighting tasks in a uniform design and quality of light thanks to the wide selection of lighting technologies, optics and surface-mounting options.